

New Shed.  
3 Meadowfield Park South  
Stodfield

Shed

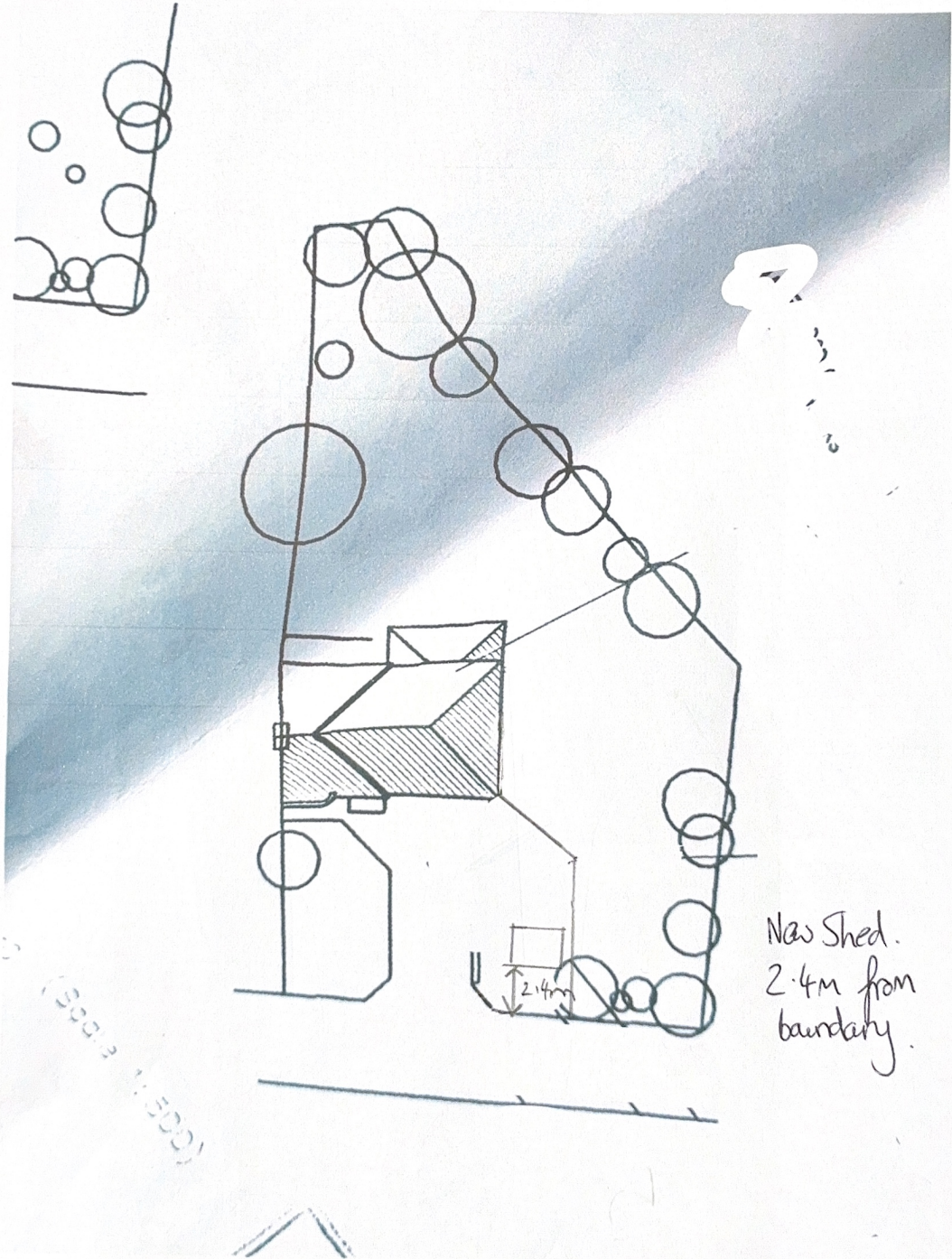

New Shed.  
2.4m from  
boundary.

(Scale 1:500)

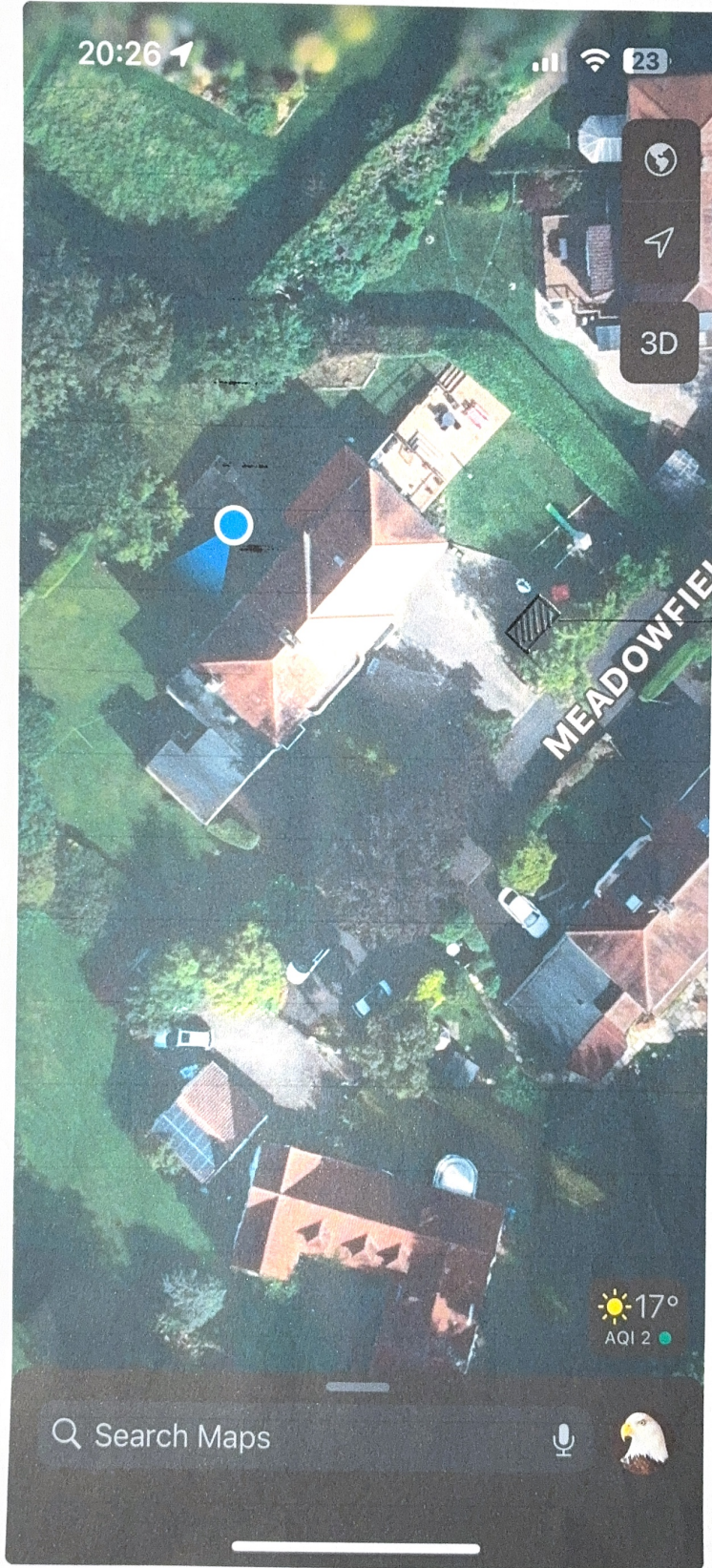

3, Meadowfield  
Park Sub

New Shed.

Land Registry  
Official copy of  
title plan

Title number **ND143100**  
Ordnance Survey map reference **NZ0660SW**  
Scale **1:1250 enlarged from 1:2500**  
Administrative area **Northumberland**

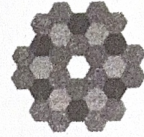

© Crown Copyright. Produced by Land Registry. Reproduction in whole or in part is prohibited without the prior written permission of Ordnance Survey. Licence Number 100026316.

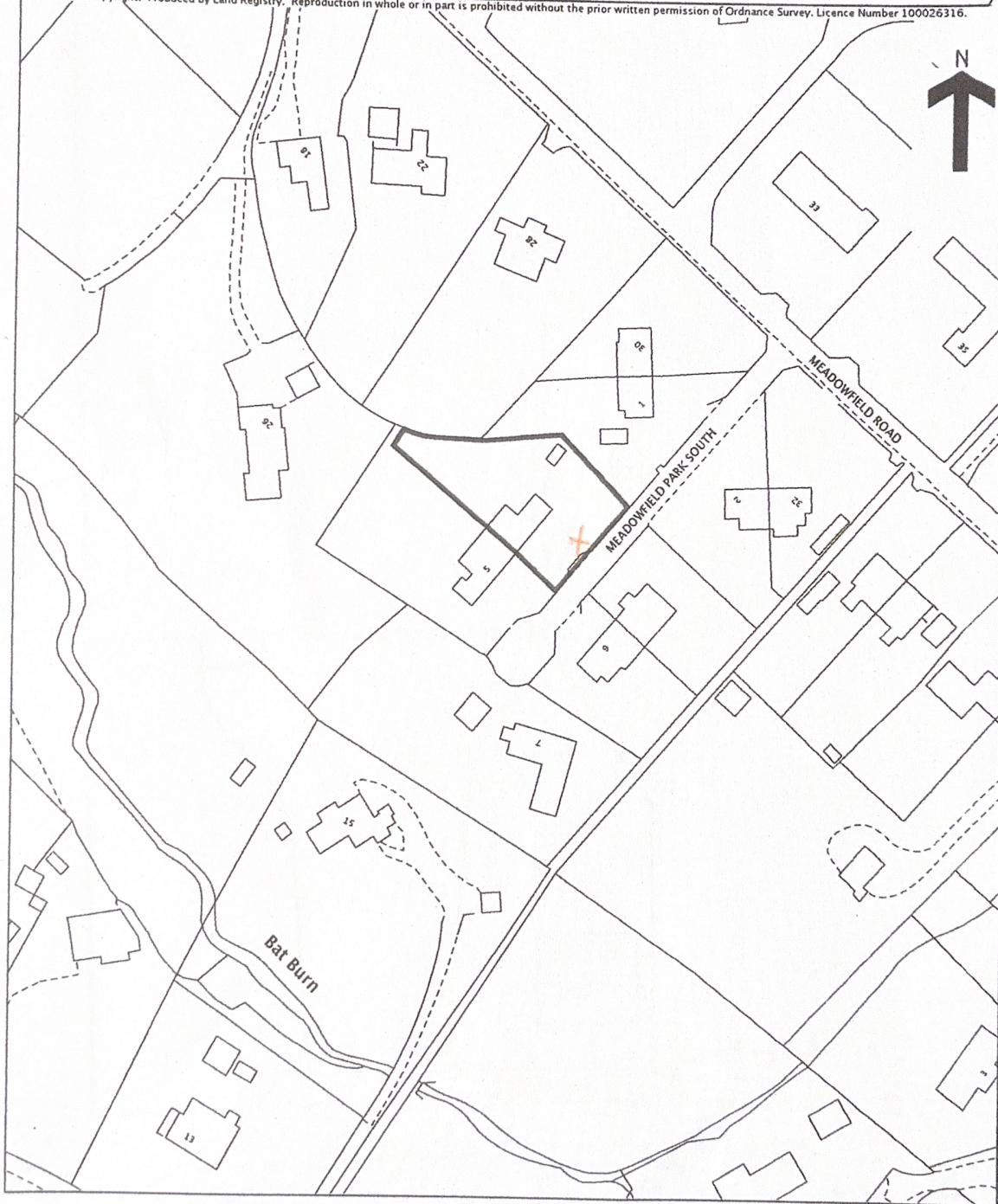

*X = shed location*  
*3 Meadowfield Park South*

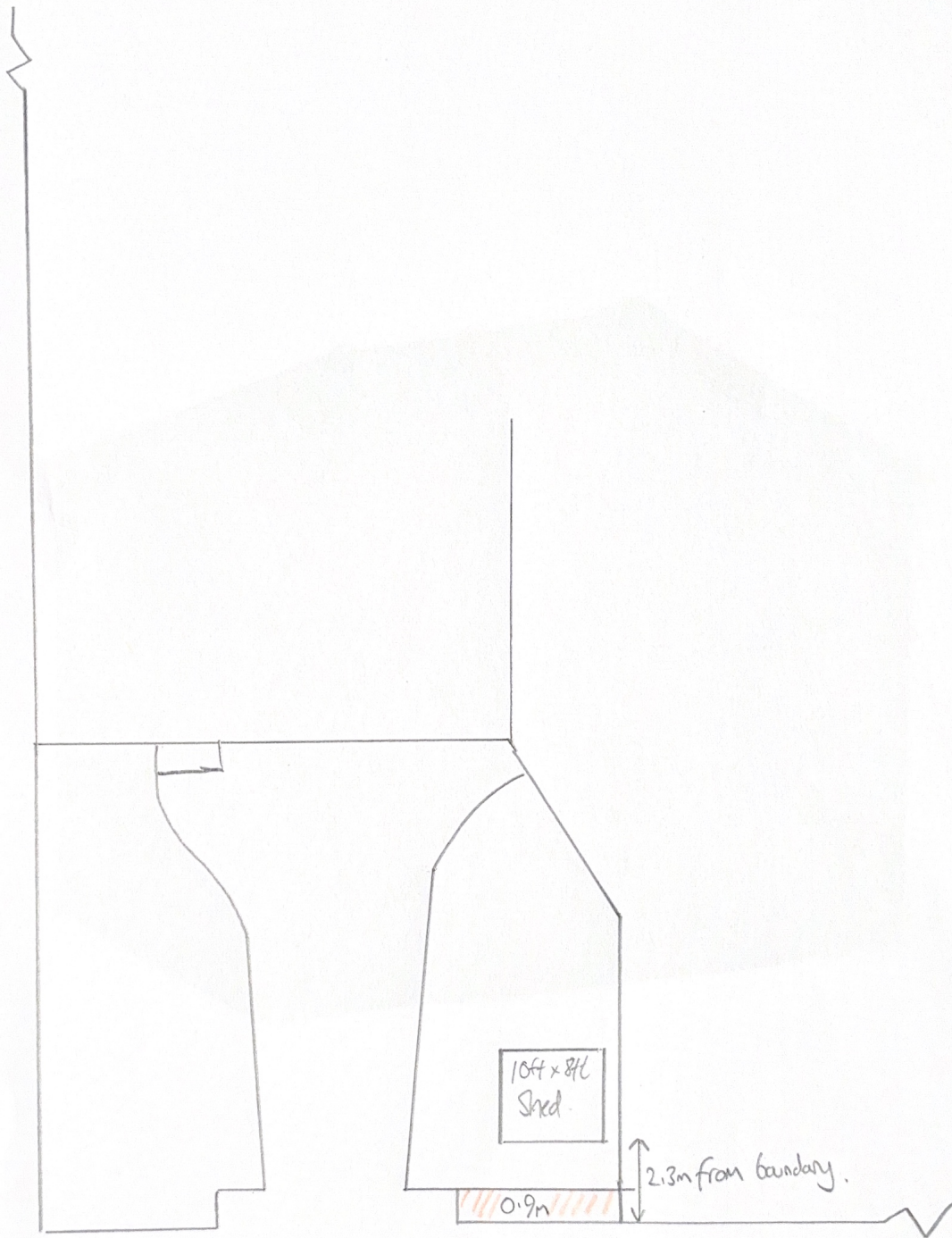

3, MEADOWFIELD PARK SOUTH



1

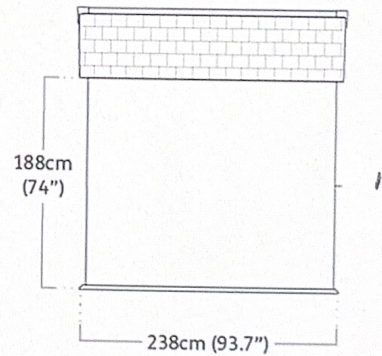
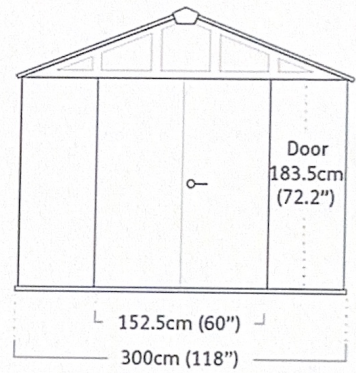
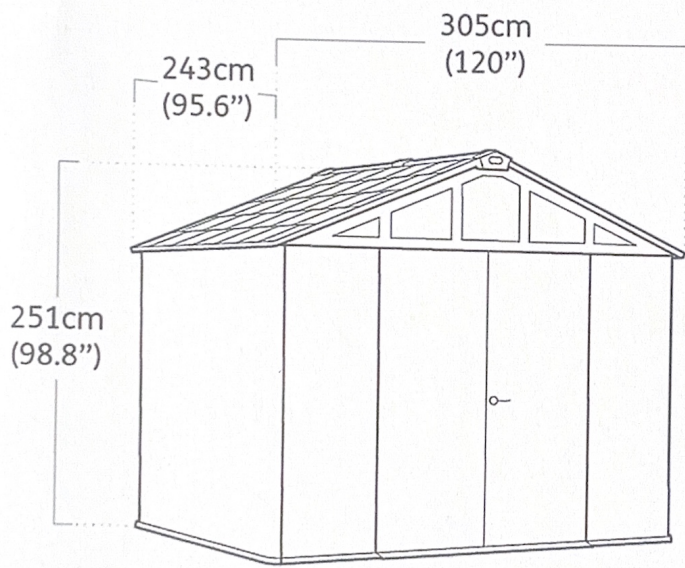

Interior Dimensions (WxDxH) : 292x222x235 cm | 115"x87.5"x92.5"

